

TRUE LOCK Proximal Radius Plates are indicated for extra-articular and intra-articular fractures of the proximal radius and multifragmented radial neck fractures.

Radius head fractures constitute 1.7-5.4% of all fractures and 33% of adult elbow fractures.

2 hole option between 3- 5 holes.

TRUE LOCK Proximal Radius Plates are made of Ti6Al4V ELI material (ASTM F136).

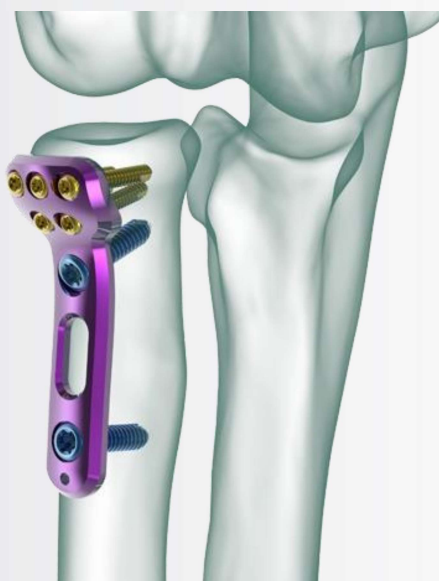

TRUE LOCK Proximal Radius Plate Features

True- Coronoid Anatomic Locking Plates are precontoured for anatomic fit. No need to bend during the surgery.

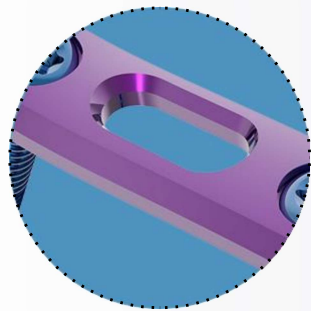

Elongated Combi hole on the shaft facilitate plate adjustment and allow locking or compression options.

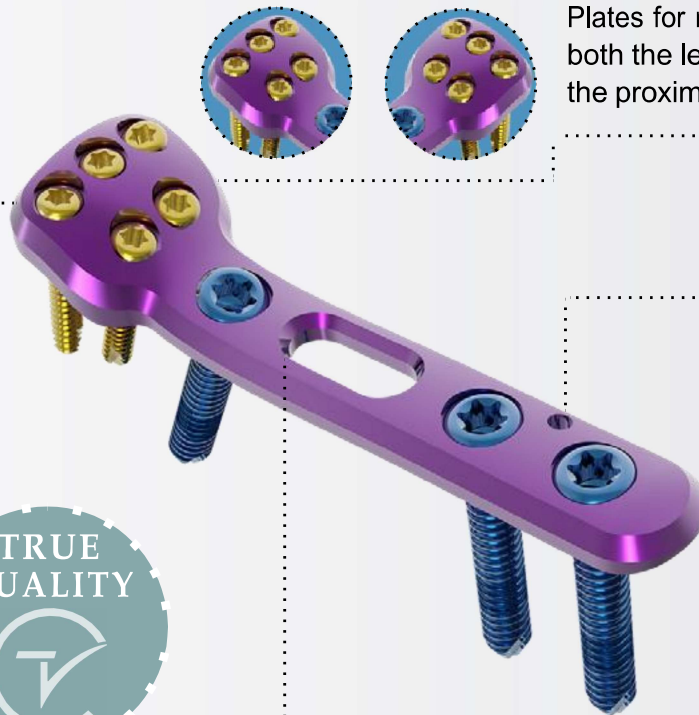

Plates for radial head neck fit both the left and right side of the proximal radius

Kirschner wire hole accept Kirschner wires (up to 1.5 mm) to temporarily fix the plate to the bone to temporarily reduce articular fragments, and to confirm the location of the plate, relative to the bone.

TRUE LOCK Proximal Radius Plate Screws Info

Reference Number:	Hole Count:	Length (mm)
200-10120-003	3 hole	45
200-10120-005	5 hole	55

- 2.3 mm Locking Cortical Screw
- 2.7 mm Non-Locking Cortical Screw
- 2.7 mm Locking Cortical Screw
- 3.5 mm Non-Locking Cortical Screw
- 3.5 mm Locking Cortical Screw
- 4 mm Non-Locking Cancellous Screw
- 4 mm Locking Cancellous Screw